

# CAPTO TRILOBATO EPS ISO 26623-1

## TOOL HOLDERS CAPTO EPS ISO 26623-1



### CALETTAMENTO A CALDO STANDARD

SHRINK FIT HOLDERS STANDARD



### PORTAPINZA ER DIN6499

COLLET CHUCK FOR ER DIN6499



### PER FRESE WELDON

END MILL HOLDERS



### PORTAFRESE FISSI

SHELL END MILL HOLDERS



### STELO TENERO LAVORABILE

BLANK ARBORS

## CARATTERISTICHE / SPECIFICATION / CARACTÉRISTIQUES/ TECHNISCHE DATEN

### CARATTERISTICHE TECNICHE

- Costruiti in acciaio certificato in barre
- Eseguiti trattamenti termici da fornitori certificati ISO 9001
- Rettificati di precisione esternamente, internamente e nelle filettature delle ghiera chiudipinza
- Controllati con strumenti di misura certificati
- L'errore di concentricità massimo tra il cono e la sede utensile è 0.003 mm

### CARACTÉRISTIQUES

- Fabriqués en bar d'acier certifié.
- Réalisation du traitement thermique par des fournisseurs certifiés ISO 9001.
- Rectification de précision extérieurement, intérieurement et dans les filetages des écrous serre-pince.
- Contrôlés par des instruments de mesure certifiés.
- L'erreur de concentricité maximum entre le cône et le siège de l'outil est de 0.003 mm.

### TECHNICAL FEATURES

- Manufactured with certificate steel
- Heat treatments are performed by certified suppliers ISO 9001
- Precision ground on shank, inside tapers and collet nut threads
- Tested with high precision inspection and gaging equipment
- The maximum error of concentricity between the cone and the seat of tool is 0.003 mm.

### MERKMALE

- Gebaut aus zertifiziertem Stabstahl
- Warmbehandlungen von Lieferanten mit Zeugnis ISO 9001
- Genauigkeitgeschliffen aussen, innen und in den Gewinden der Spannmutter für den Zangenverschluss
- Geprüft mit zertifizierten Messinstrumente
- Die max konzentrische Abweichung zwischen Konus und Werkzeugsitz ist 0.003 mm



# CALETTAMENTO A CALDO

## SHRINK FIT HOLDERS

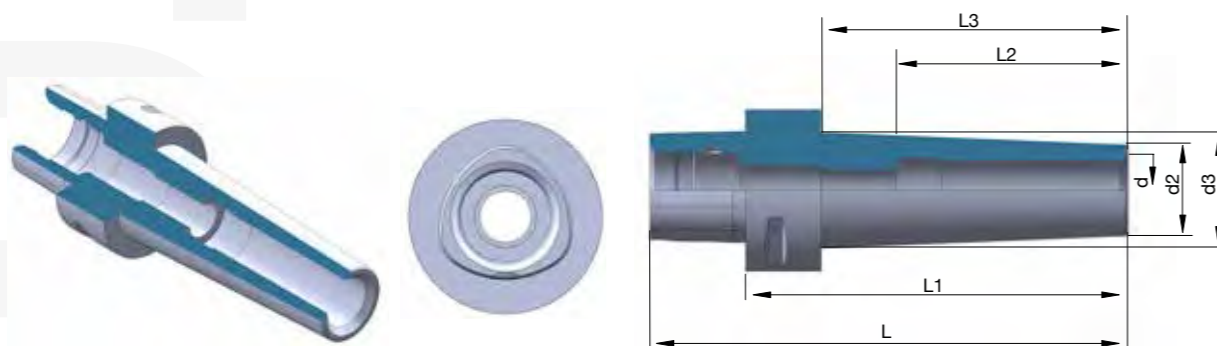
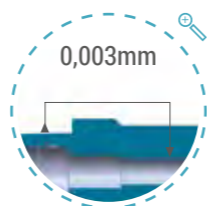

### CALETTAMENTO STANDARD - SHRINK FIT HOLDERS

Cod.	TYPE	L	l1	l2	l3	AT2		G2.5/25000	
						d1	d2	d3	
CPT.63.80.CL6	CAPTO63 H80 CL6	118	80	36	53	6	20	26	
CPT.63.80.CL8	CAPTO63 H80 CL8	118	80	36	53	8	20	26	
CPT.63.80.CL10	CAPTO63 H80 CL10	118	80	42	53	10	24	32	
CPT.63.80.CL12	CAPTO63 H80 CL12	118	80	47	56	12	24	32	
CPT.63.85.CL14	CAPTO63 H85 CL14	123	85	47	58	14	27	34	
CPT.63.85.CL16	CAPTO63 H85 CL16	123	85	50	58	16	27	34	
CPT.63.85.CL18	CAPTO63 H85 CL18	123	85	52	58	18	33	42	
CPT.63.85.CL20	CAPTO63 H85 CL20	123	85	52	58	20	33	42	
CPT.63.90.CL25	CAPTO63 H90 CL25	128	90	58	66	25	44	53	
CPT.63.95.CL32	CAPTO63 H95 CL32	133	95	58	71	32	44	53	

# PORTAPINZA ER DIN6499

## COLLET CHUCK ER DIN6499

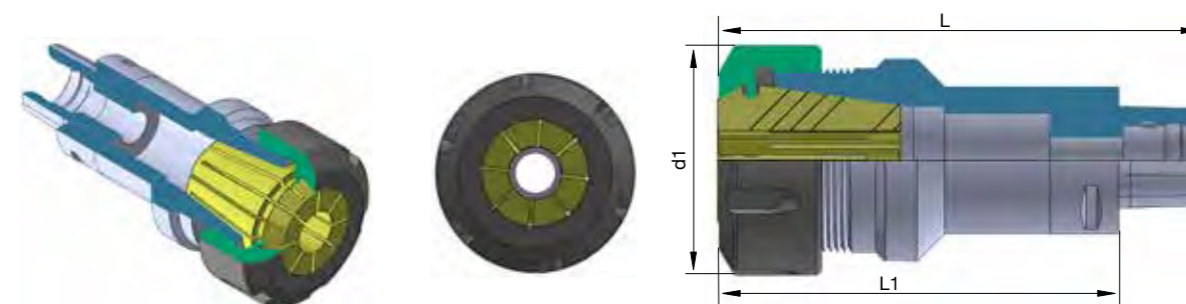
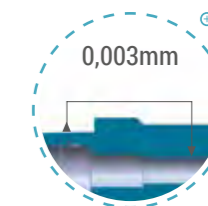

### PORTAPINZA ER - COLLET CHUCK ER

Cod.	TYPE	L	l1	AT2		G2.5/25000	
				d1	CAPACITÀ RANGE		
CPT.63.100.ER16	CAPTO63 H100 ER16	138	100	28	1 ÷ 10 mm		
CPT.63.60.ER20	CAPTO63 H60 ER20	98	60	34	2 ÷ 13 mm		
CPT.63.60.ER25	CAPTO63 H60 ER25	98	60	42	2 ÷ 16 mm		
CPT.63.100.ER25	CAPTO63 H100 ER25	138	100	42	2 ÷ 16 mm		
CPT.63.70.ER32	CAPTO63 H70 ER32	108	70	50	3 ÷ 20 mm		
CPT.63.100.ER32	CAPTO63 H100 ER32	138	100	50	3 ÷ 20 mm		
CPT.63.65.ER40	CAPTO63 H65 ER40	103	65	63	3 ÷ 26 mm		

# PER FRESE WELDON

## END MILL HOLDERS

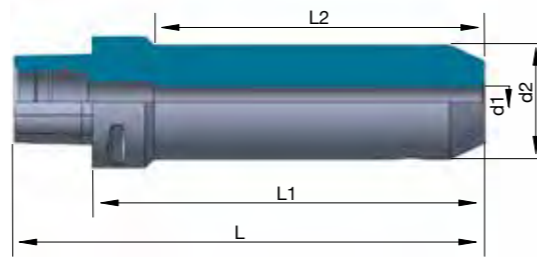
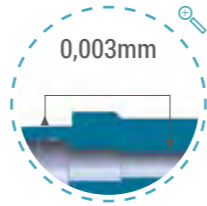

### PER FRESE WELDON - END MILL HOLDERS

Cod.	TYPE	L	l1	L2	AT2		G6.3/10000	
					d1	d2	T	
CPT.63.55.WE6	CAPTO63 H55 WE6	93	55	25	6	25	M6	
CPT.63.55.WE8	CAPTO63 H55 WE8	93	55	26	8	28	M8	
CPT.63.60.WE10	CAPTO63 H60 WE10	98	60	30	10	35	M10	
CPT.63.60.WE12	CAPTO63 H60 WE12	98	60	33	12	42	M12	
CPT.63.60.WE14	CAPTO63 H60 WE14	98	60	33,5	14	44	M12	
CPT.63.65.WE16	CAPTO63 H65 WE16	103	65	35,5	16	48	M14	
CPT.63.65.WE18	CAPTO63 H65 WE18	103	65	39	18	50	M14	
CPT.63.65.WE20	CAPTO63 H65 WE20	103	65	37,5	20	52	M16	
CPT.63.80.WE25	CAPTO63 H80 WE25	118	80	58	25	65	M18	
CPT.63.90.WE32	CAPTO63 H90 WE32	128	90	68	32	72	M20	
CPT.63.100.WE40	CAPTO63 H100 WE40	138	100	77	40	90	M20	

# PORTAFRESE FISSI

## SHELL END MILL HOLDERS

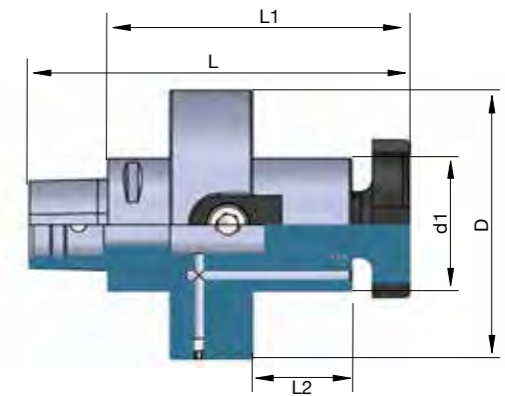
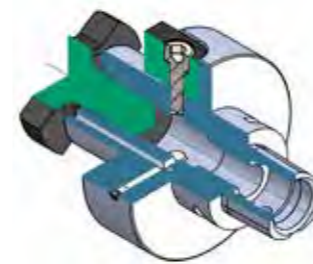
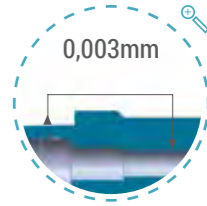

### PORTAFRESE FISSI - SHELL END MILL HOLDERS

Cod.	TYPE	L	l1	l2	AT2		G6.3/10000	
					D	d1		
CPT.63.35.D16S	CAPTO63 H35 D16S	90	35	17	38	16		
CPT.63.40.D22S	CAPTO63 H40 D22S	92	40	19	48	22		
CPT.63.40.D27S	CAPTO63 H40 D27S	99	40	21	60	27		
CPT.63.40.D32S	CAPTO63 H40 D32S	102	40	24	78	32		
CPT.63.45.D40S	CAPTO63 H45 D40S	110	45	27	80	40		

# STELO TENERO LAVORABILE

BLANK ARBORS

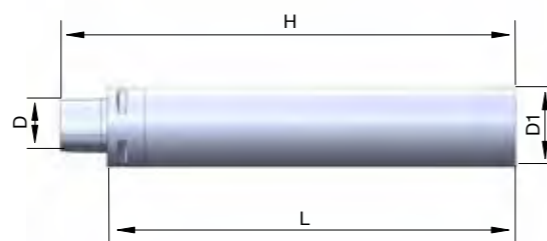

## STELO TENERO LAVORABILE - BLANK ARBORS

Cod.	TYPE	D	D1	G6.3/10000	
				AT2	
CPT.63.180.BL63	CAPTO63 H180 D63BL	63	63	180	158
CPT.63.180.BL120	CAPTO63 H180 D120BL	63	120	180	158

